

202 Potters Pass Drive

Nexton | Summerville, SC 29486

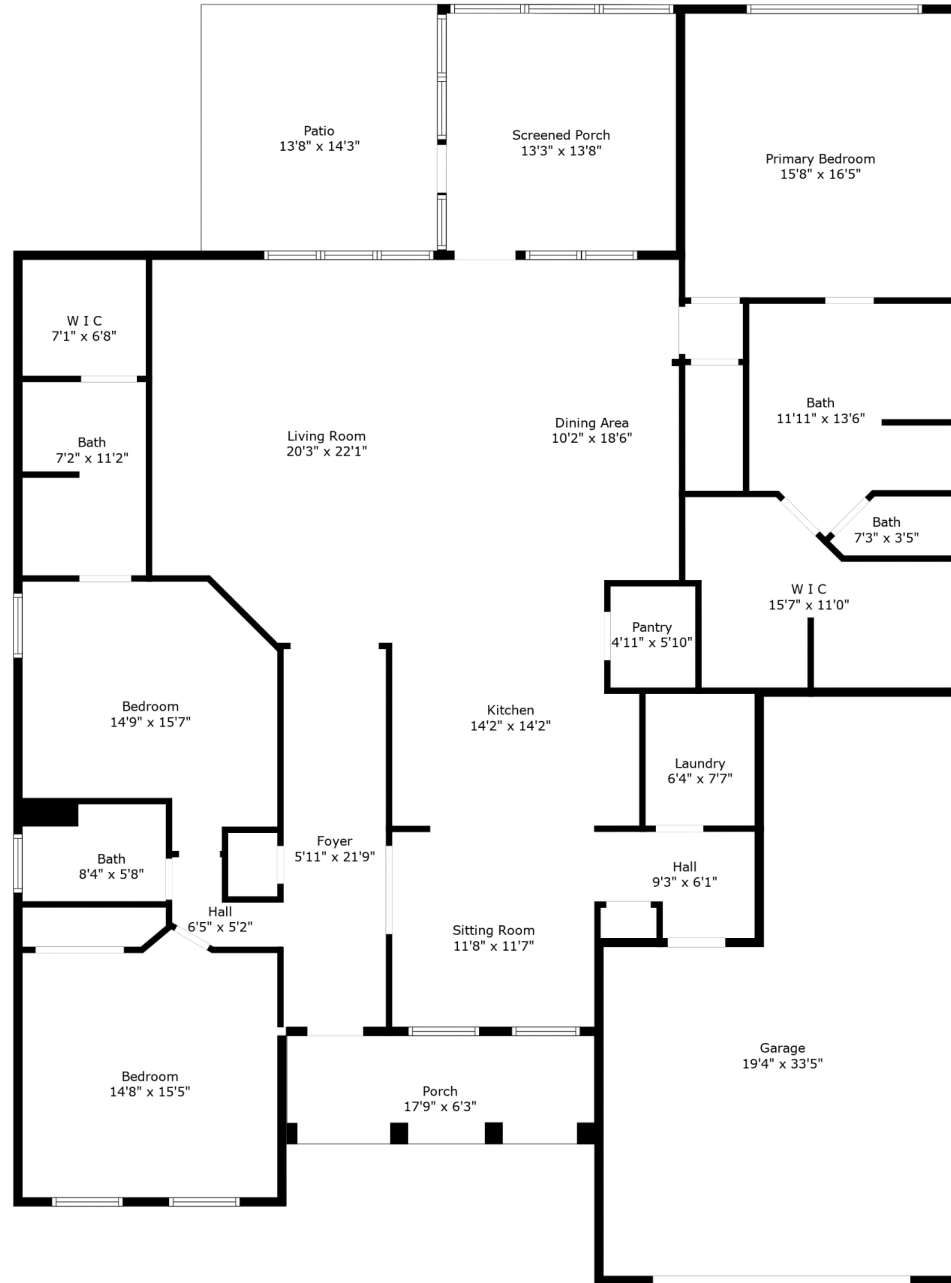

TOTAL: 2661 sq. ft

FLOOR 1: 2661 sq. ft

EXCLUDED AREAS: GARAGE: 547 sq. ft, PORCH: 111 sq. ft, PATIO: 194 sq. ft

Measurements Are Calculated By Cubicasa Technology. Deemed Highly Reliable But Not Guaranteed.

