

Dan Pape, GRI, ABR, REALTOR® ~ Representing Buyers and Sellers Throughout the Lowcountry!

~ **107 Retriever Lane** ~

Woodland Lakes, Goose Creek, SC 29445

MLS# 1110271, 3 Bdrms, 2 Baths, 1,976 S/F



LP: \$165,000.

(Cost per Sq. Ft.: \$83.50)

- Lovely updated & upgraded one-story home, built in 1991!
- Expansive great room with vaulted ceiling, fireplace and wet bar
- Separate formal dining room and eat-in kitchen with access to large deck and fenced back yard
- Large master bedroom with upgraded bath
- Upgrades include plush carpet, ceramic tile in kitchen and baths, plus new low maintenance vinyl siding on the exterior!
- Attached 2-car garage with interior access
- Nicely landscaped yard with mature trees
- Established neighborhood with easy access to nearby shopping and Goose Creek Community Center

*View this Property at my Web-Sites below,
as well as: HomesandLand.com, Trulia.com,
Yahoo.realestate.com, Realtor.com, YouTube, etc. !!!*

www.danpapescrealestate.com

www.longpointteam.com

©
Carolina One
Real Estate

DIRECT 843.849.5215
MOBILE 843.870.4539
Dpape@carolinaone.com

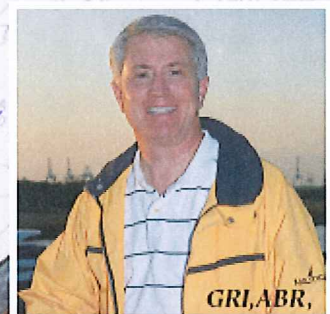

Dan Pape

*Come high winds
or rough seas,
Dan will be there to
assist you with your
real estate needs!*

Building Sketch

Client	Dan Pape of Carolina One Real Estate		
Property Address	107 Retriever Ln		
City	Goose Creek	County Berkeley	State SC Zip Code 29445-4011
Client	Dan Pape of Carolina One Real Estate		

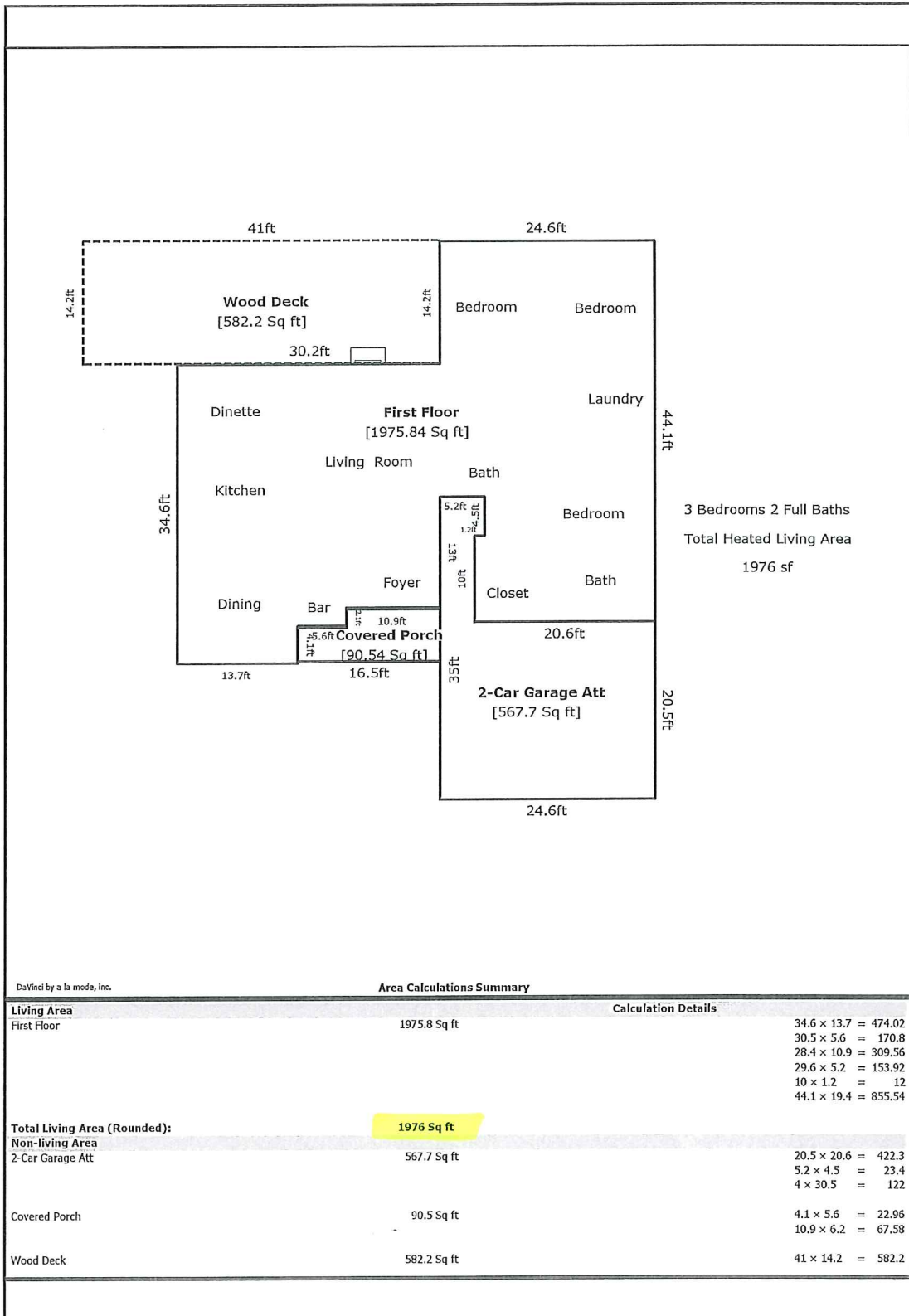

DaVinci by a la mode, inc.

Area Calculations Summary

Living Area	Area	Calculation Details
First Floor	1975.8 Sq ft	$34.6 \times 13.7 = 474.02$ $30.5 \times 5.6 = 170.8$ $28.4 \times 10.9 = 309.56$ $29.6 \times 5.2 = 153.92$ $10 \times 1.2 = 12$ $44.1 \times 19.4 = 855.54$
Total Living Area (Rounded):	1976 Sq ft	
Non-living Area		
2-Car Garage Att	567.7 Sq ft	$20.5 \times 20.6 = 422.3$ $5.2 \times 4.5 = 23.4$ $4 \times 30.5 = 122$
Covered Porch	90.5 Sq ft	$4.1 \times 5.6 = 22.96$ $10.9 \times 6.2 = 67.58$
Wood Deck	582.2 Sq ft	$41 \times 14.2 = 582.2$